

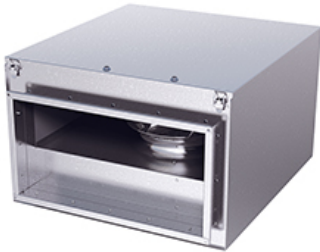

ÖSTBERG 

IRB 600X300 B3



- Insulated duct fan with rectangular connections.
- Equipped with 50 mm of thermal and acoustic insulation makes it ideal for handling cold air.
- Designed for high pressure and long, complicated duct runs.
- The design prioritise functionality, durability and longevity.
- Impeller with backward curved blades.
- The external rotor motor has maintenance-free sealed ball-bearings.
- Integrated motor protection.
- Junction box has enclosure class IP 54.
- For speed control a transformer can be connected.
- The housing is manufactured from galvanized sheet steel.
- The fan is intended to be installed in a duct system.
- A duct connected fan can be installed outside or in damp environments.





www.ostberg.com

DIAGRAMS

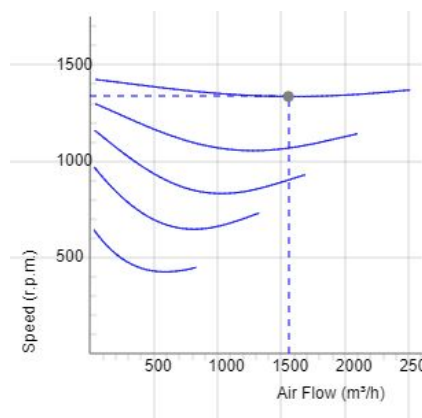
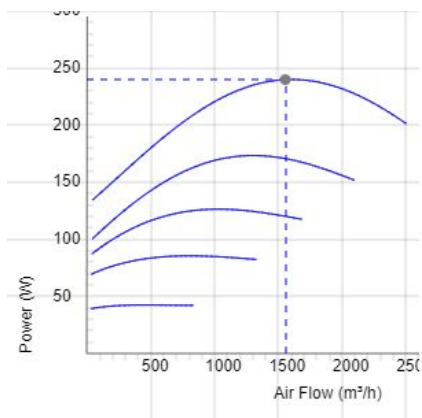
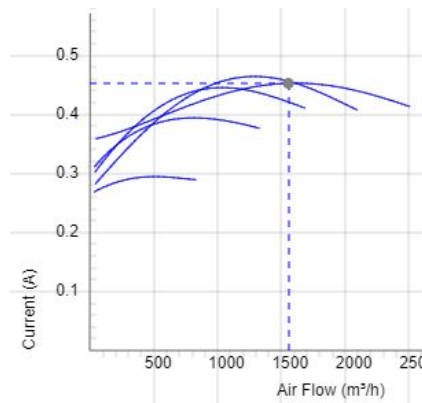
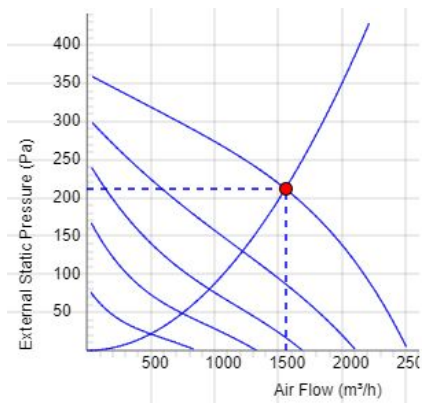

Data

Air Flow (m³/h) 1555	External static pressure (Pa) 212	Power (W) 240	Speed (r.p.m.) 1336	Current (A) 0.453	Voltage (V) 400
-------------------------	--------------------------------------	------------------	------------------------	----------------------	--------------------





DIAGRAMS

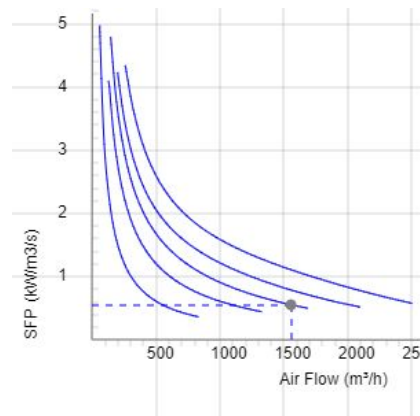
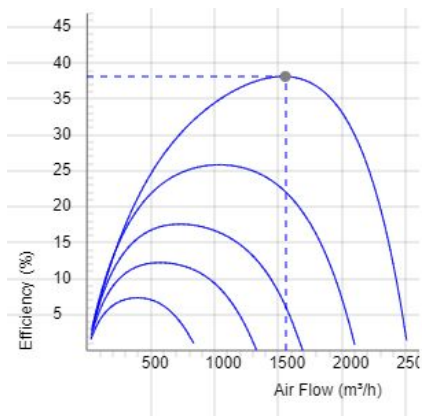

DATA

Efficiency (%)	38.1
SFPv (kW/m ³ /s)	0.555

SOUND DATA

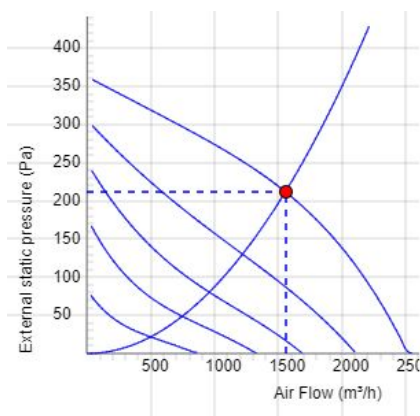

	Tot	63	125	250	500	1k	2k	4k	8k
Inlet Lw dB(A)	64	50	62	56	48	42	41	41	38
Outlet Lw dB(A)	70	53	68	64	57	58	53	50	47
Surrounding Lw dB(A)	57	34	56	51	40	38	35	35	30
Surrounding Lp dB (A) 20m ² Sabine, hemispherical 3m	50								

Data - SOUND

Air Flow (m ³ /h) 1555	External static pressure (Pa) 212	Power (W) 240	Speed (r.p.m.) 1336	Current (A) 0.453	Efficiency (%) 38.1	SFPv (kW/m ³ /s) 0.555	Voltage (V) 400
--------------------------------------	--------------------------------------	------------------	------------------------	----------------------	------------------------	--------------------------------------	--------------------



TECHNICAL DATA

IRB 600x300 B3 7890104

Parameter	Value	Unit
Voltage	400	V
Voltage Delta	230	V
Phase	3	~
Frequency	50	Hz
Power	240	W
Current	0.45	A
Current when speed controlled	0.46	A
Current Delta	0.78	A
Current Delta when speed controlled	0.8	A
Speed	1340	r.p.m.
Max. temperature of transported air	80	°C
Max. temperature of transported air when speed controlled	80	°C
Sound pressure level at 3 m	52	dB(A)
Weight	45.3	kg
Enclosure class	54	IP
Insulation class, motor	F	
Capacitor	-	µF
Max. flow @ 0Pa	2516.4070459397	m ³ /h
Max. pressure	360	Pa
Voltage range	380-415	V





www.ostberg.com

PRODUCT INFORMATION SHEET

Parameter	Value	Unit
(a) Manufacturer	Östberg	-
(b) Model code	IRB 600x300 B3	-
(c) Declared type	NRVU / UVU	-
(d) Type of drive	Multi-speed drive	-
(e) Type of HRS	N/A	-
(f) Thermal efficiency	N/A	%
(g) Nominal flow rate	0.341	m ³ /s
(h) Effective power input	0.235	kW
(i) SFP int	N/A	W/(m ³ /s)
(j) Face velocity	2.7	m/s
(k) Nominal external pressure	260	Pa
(l) Internal pressure drop	N/A	Pa
(n) Static efficiency	44.9	%
(o) External (and internal) leakage rate	0.11	%
(p) Filter classification	N/A	kWh
(q) Visual filter warning	N/A	-
(r) Sound power level	59	dB LwA
(s) Disassembly instructions	www.ostberg.com	-



www.ostberg.com

WIRING DIAGRAM

4040003 Δ 230V

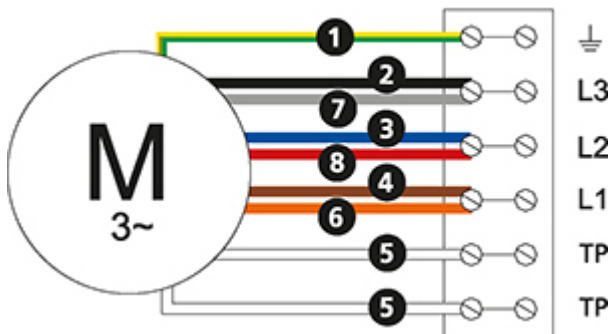

4040004 Y 400V

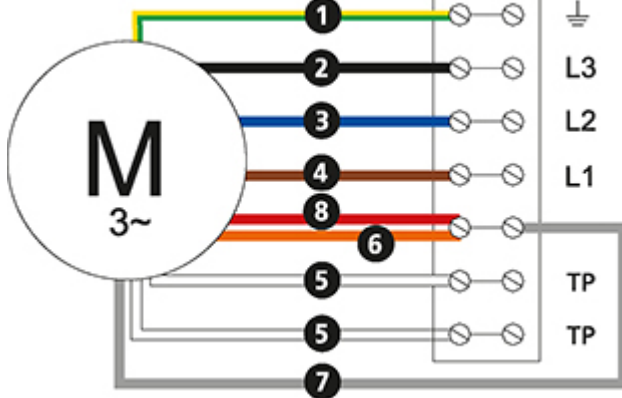

(M) = Fan Motor

(M1) = Fan Motor

(M2) = Fan Motor

(M3) = Rotor Motor

① = Yellow/Green

② = Black

③ = Blue

④ = Brown

⑤ = White

⑥ = Orange

⑦ = Grey

⑧ = Red

⑨ = Green

⑩ = Violet

⑪ = Quick switch

⑫ = Yellow

ÖSTBERG 

DIMENSIONS

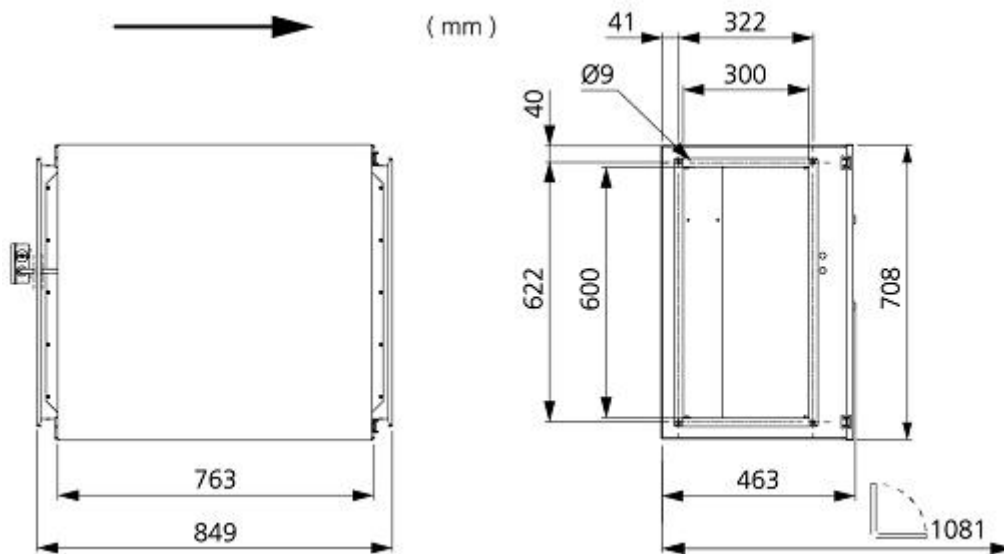

ACCESSORIES

Mechanical accessories



Mounting bracket Kit Universal



Kit Flexible connection 600x300



Silencer LDR 600x300

Electrical accessories



Transformer controller VRTT 1



Transformer controller VRDT 2